

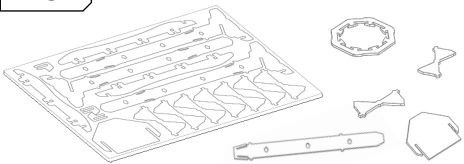

ASSEMBLY VIDEO
cutt.ly/crystal-twister-assembly



PREPARATION I
 Separate all parts. Use gloves



PREPARATION II
 Remove protective film from all parts

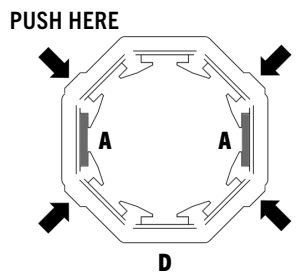
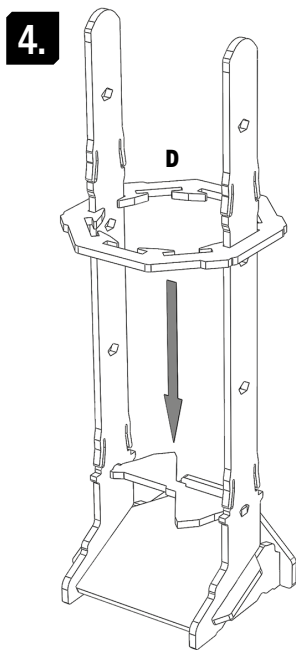
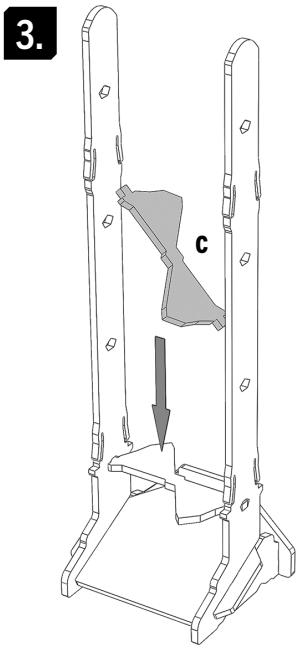
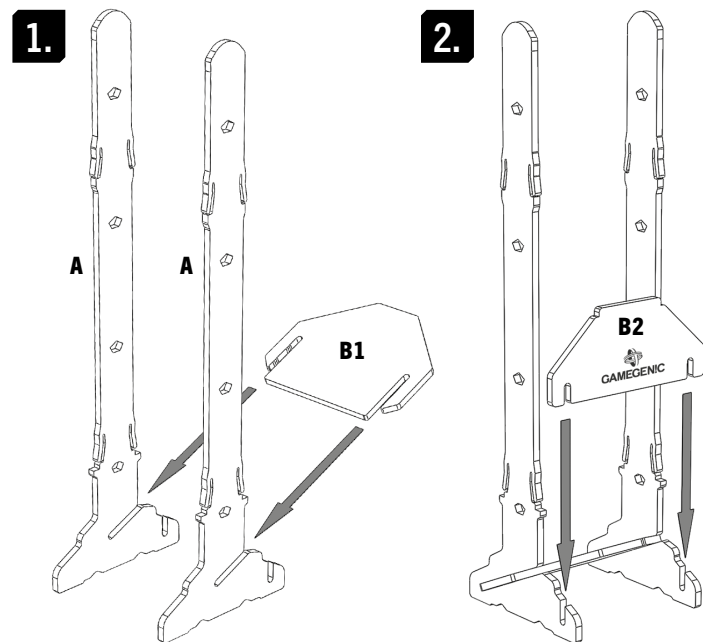
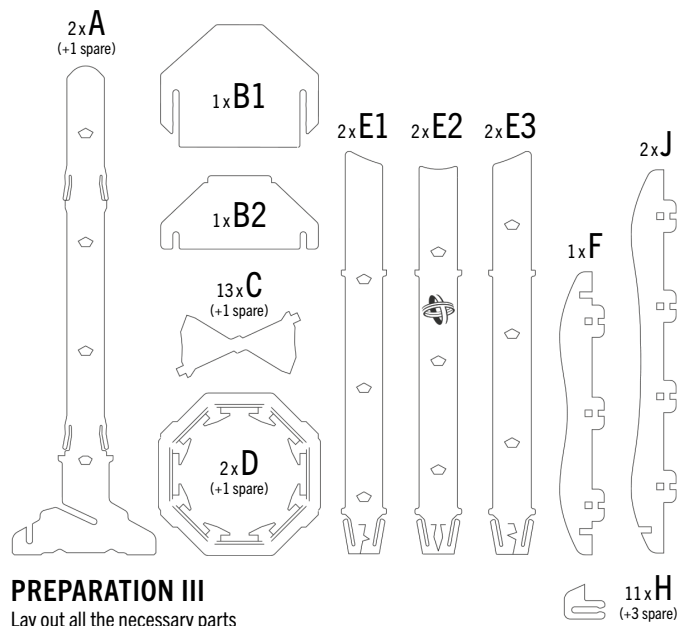
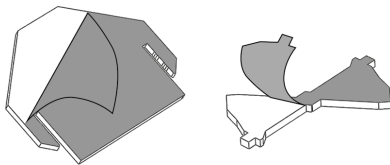

CORRECT POSITION: "CLICK!"

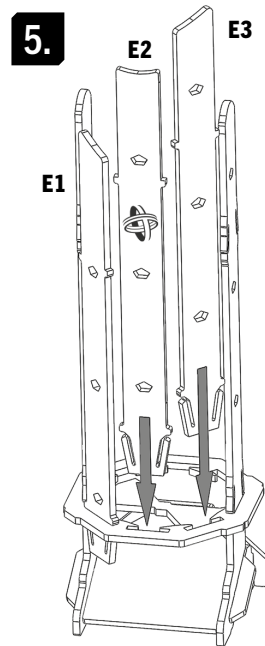
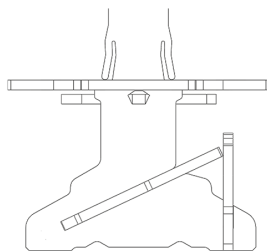

PICTOGRAMS HELP YOU TO PUT THE PIECES INTO THE RIGHT POSITIONS

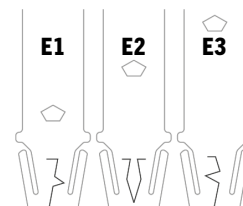

CORRECT STAIRS POSITION

